

Programs at Fairview Lake

Conference Center

- Retreats
- Recreation
- Training Sessions
- Team Building
- Trust Activities
- Leadership Training

Great Site for One Day Seminars

Cross Country Skiing

Environmental Education

- School Groups
- Adventure Based Programs
- Teacher Workshops

Summer Resident Camp

- (Children 7-16 Years of age)
- Traditional Summer Camp

Ranch Camp

- Sailing/Windsurfing Camp
- Environmental Trips for Challenge

Volunteer Weekends

For more information, call the camp office at
973-383-9282

Group and Conference Camping

**FAIRVIEW LAKE
CAMPS AND CONFERENCE
CENTER**
METRO YMCA'S OF THE ORANGES



We build strong kids, strong families, strong communities.

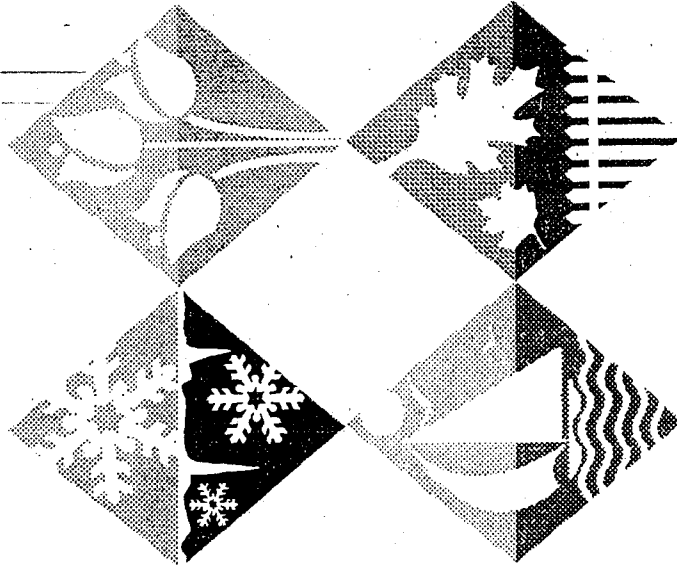

FOR ANY TIME OF THE YEAR!!

1035 Fairview Lake Road
Newton, NJ 07860
973-383-9282

Group, Conference and Family Camping

Fairview Lake Camps is available to organizations and families during the Spring, Fall and Winter seasons. Many business, church, school, YMCA, Scout, senior and civic groups - over 15,000 participants per year - are using these facilities for conferences, environmental education, retreats, and recreational weekends. The camp is suited for coed, youth, adult, senior and family oriented groups. **Ideal site for day long training events.**

Ideal Setting

Fairview Lake Camps is located in the southwestern corner of Sussex County in Stillwater, New Jersey, just 67 miles from the heart of the New York metropolitan area. Mile-long Fairview Lake is our center of interest and has the beauty of the Kittatinny Ridge as a backdrop. The camp also features 600 acres of unspoiled woodlands, open fields and running streams. The YMCA property is adjacent to the Delaware Water Gap National Recreation Area and the Appalachian Trail. The camp provides a beautiful "away-from-it-all" atmosphere that can enhance a wide variety of group programs.

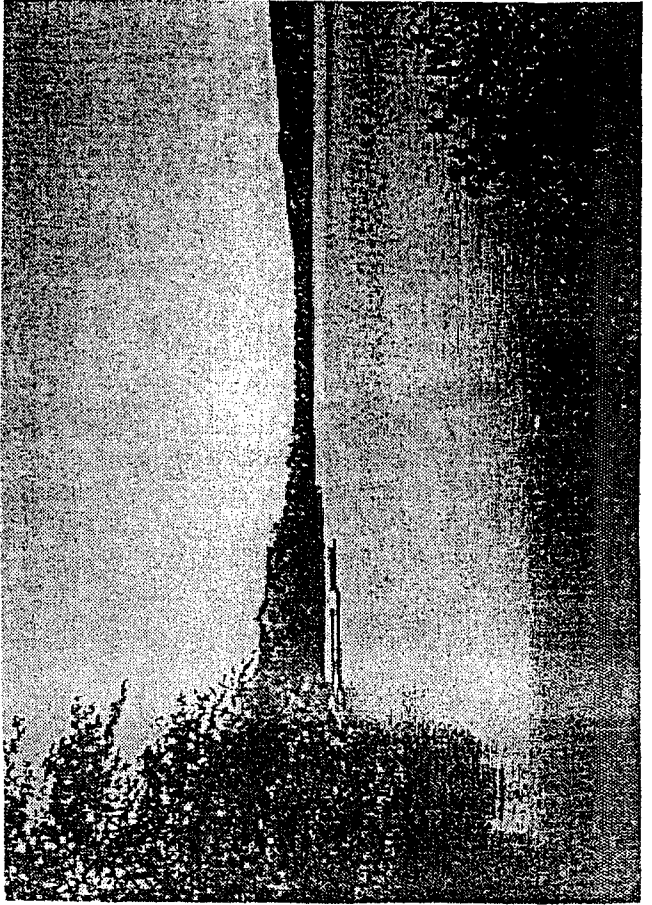

Nearby Attractions

- * The Appalachian Trail and Delaware Water Gap National Recreation Area.
- * Vernon Valley - Mountain Creek Ski Resort
- * Millbrook and Waterloo Villages, both working restorations of historical sites featuring life styles of a by-gone era.
- * Sterling Hill Mining Museum in Ogdensburg.

All Roads Lead to Fairview Lake

Rt. 80 West to Exit 25. Rt. 206 North to Newton. Take Rt. 94 South for 3 1/2 miles to blinking light. Right onto Rt. 610 to Stillwater. Bear right on to Rt. 521 North. Make 2nd left (uphill) onto Fairview Lake Road. Continue for 4 miles. The camp entrance will be on the left hand side.

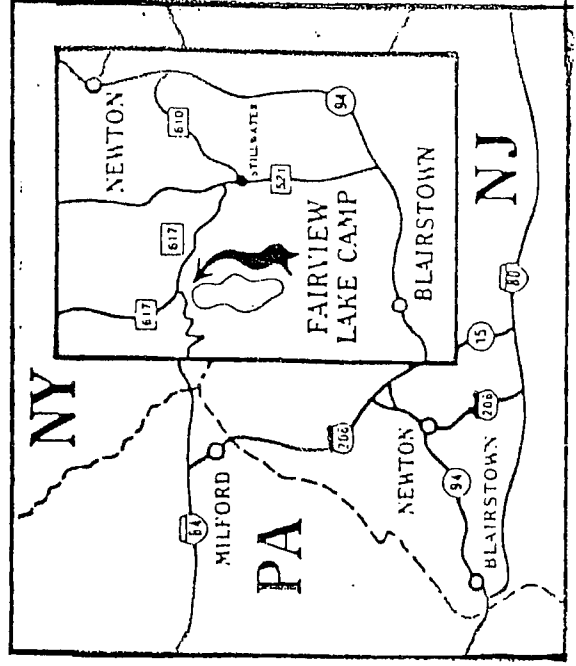

Rustic Cabins Spring & Fall

All of the facilities listed below are rustic. Electrical outlets are available in the washroom buildings only. Each of the three units contain fire pits for cooking and/or camp fires.

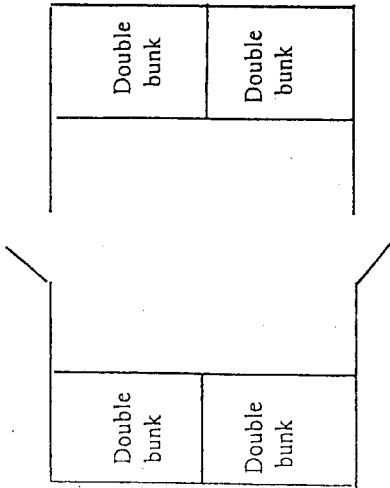

Delaware Unit

Nine cabins nestled on the hillside, each with eight built-in bunks. Community-type bath facilities are located within the unit area: a large athletic field is nearby. Capacity is 72 people.

Warrior Unit

Seven cabins accommodating eight each with four bunk beds. A bathhouse and basketball court are located in the unit. Kittatinny Program Lodge and Wakigan Waterfront are close by. Capacity is 56 people.

Wakigan Unit

Ten Adirondack shelters accommodating four people each with two bunk beds. The Wakigan unit has a central bathhouse and features its own waterfront area. Capacity is 40 people.

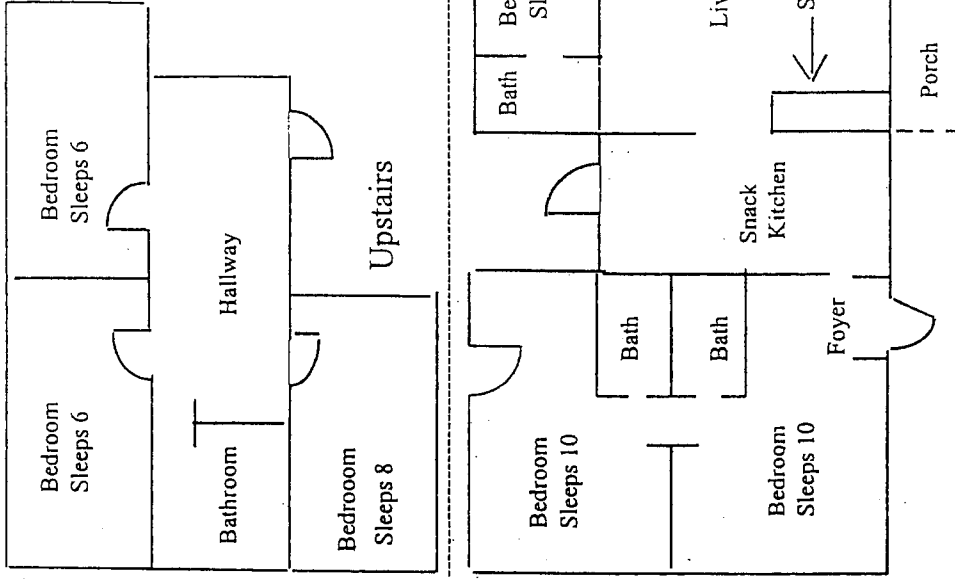

Wickapeck Lodge

Capacity - 52

This cozy lodge, one of the original farmhouses on the property, has three bedrooms and a bathroom upstairs; two bedrooms, a bathroom and a large living room with a fireplace downstairs (each bedroom accommodates six people) plus a dormitory wing with 20 beds and two bathrooms. This lodge is ideal for staff training, team building, coed groups and has central heating for winter use.

